



Service-Information

Frontlader Waschvollautomat

AWM 8123/1

8570 812 29600

Letzte Änderung: 07.06.2008

Anlagedatum: 07.06.2008

Ersatzteilliste	2
Explosionszeichnung	5
Anschlußplan	7
Stromlaufplan	8
Programmablaufplan	9
Text /Legende	14

Die vorliegenden Serviceunterlagen sind ausschließlich für technisch qualifizierte Fachkräfte bestimmt, welche mit den entsprechenden einschlägigen Sicherheitsvorschriften vertraut sind.
Änderungen vorbehalten

Ersatzteilliste

Pos-Nr.	12NC	Beschreibung
001 0	4819 440 19716	Gehaeuse
002 0	4812 440 19343	Klappe Filteroeffnung
011 0	4819 462 48472	Fuss
021 0	4812 440 19818	Front
024 0	4812 440 18998	Rueckwand
025 0	4812 404 38551	Traeger Steuerung VBL WH
030 0	4812 310 18586	Arbeitsplatte VBL WH
040 0	4812 417 18787	Scharnier
050 0	4812 440 10406	Sockel
061 0	4812 466 88458	Gegengewicht oben
061 1	4812 466 88459	Gegengewicht vorne
061 2	4819 310 39227	Montagesatz Gewicht oben
061 3	4819 310 39228	Montagesatz Gewicht unten
081 0	4812 529 18038	Stosssdaempfer bis 1200
084 0	4812 466 58001	Silentblock
086 1	4812 401 18413	Halter Stosssdaempfer
086 2	4812 401 18412	Stopfen Stosssdaempfer
110 0	4812 498 18139	Handgriff Tuer weiss
130 0	4812 417 28047	Platte Tuerschloss
130 1	4812 417 28048	Platte Tuerschloß unten
131 0	4812 417 28046	Verschluss Tuer
131 1	4812 417 28045	Stift Tuerverschluss
131 2	4812 492 58022	Feder Tuerverschluss
135 1	4812 498 18137	Knopf Tuersicherung
135 2	4812 491 48004	Feder Tuersicherung
135 3	4812 290 68153	Justier-Element Tuersicherung
140 0	4812 450 68219	Schauglas
143 0	4812 440 19782	Fensterrahmen VBL WH
144 0	4812 440 19589	Rahmen Schaugl. DE-WT
191 0	4812 460 68527	Manschette Standard
191 0	4812 460 68532	Manschette WH fettbest
191 1	4812 492 18017	Schelle
191 2	4819 530 58059	Ring
200 1	4812 418 18283	Bottich 53l vorn
200 2	4812 418 18305	Bottich 53l hinten
200 4	4812 290 88054	Klemme fuer Behaelter
220 0	4812 418 18288	Trommel 53l, 1200
271 0	4819 358 18152	Riemen
272 0	4812 528 58027	Riemenscheibe DIAM.298
272 2	4812 532 18024	U-Scheibe
272 3	4812 505 18371	Mutter M 12
292 0	4812 530 58101	Dichtung Behaelter
301 0	4812 452 10954	Schalterleiste AWM 8123/1
303 0	4812 498 78097	Handgriff
321 0	4812 452 10951	Einlage bed.
321 1	4812 532 98011	Befestigung f. Einlage
331 0	4812 414 58111	Knopf Timer VBL kpl.
332 1	4812 513 18097	Drucktaste Start VBL WH
332 2	4812 513 18098	Drucktaste Drehzahl VBL WH
332 3	4812 513 18099	Drucktaste Optionen VBL WH

Pos-Nr.	12NC	Beschreibung
332 4	4812 513 18101	Drucktaste plus VBL WH
332 5	4812 513 18102	Drucktaste minus VBL WH
400 0	4812 361 58172	Motor 1200 MCA 61
409 0	4812 362 48004	Kohlebuerste Motor CES
421 0	4812 121 18142	Entstoerfilter 1,00 µF
430 0	4812 310 18458	Pumpe SERVICE SET
451 0	4812 259 28759	Heizelement 2050W + NTC
480 0	4812 321 78109	Kabel Motor SC1/OM PP/ALPHA/GA
490 0	4819 321 18136	Netzkabel 2m SA
491 0	4812 321 28367	Zugentlastung
500 0	4812 282 18899	Timer SC1 (EI,EC,PW,IR,RH)
571 0	4812 271 28375	Magnetventil einfach
581 0	4812 276 18327	Niveauschalter 55/35
620 0	4812 239 58002	Modul "A" C/DS
630 0	4812 280 58026	Tuerverriegel. 3 TABS
691 0	4812 282 18702	Sensor NTC (SC1,OMEGA,ACCESS)
701 0	4819 530 28848	Zulaufschlauch
701 1	4819 466 69704	Dichtung und Filter
702 0	4819 530 29019	Schlauch intern
707 0	4812 526 48033	Duese schwenk 4
707 1	4812 526 48028	Duese Einspuelung
708 1	4812 530 48143	Kruemmer Zulauf
711 0	4812 418 88055	Waschmittelk. 4 K. 53 l
712 0	4812 418 79703	Schublade 4 VBL ASS
713 0	4812 418 88028	Klappe Einspuelb. 4x
717 0	4812 418 78925	Bowdenzug
717 1	4812 321 38013	Hebel , Duese
717 2	4812 321 38012	Justier-Element
717 3	4812 278 88017	Gleitstueck
717 4	4812 492 38359	Feder , Duese
717 5	4812 282 18806	Nocken 4 K. SC1/VBL/WH
718 0	4812 526 48051	Saugheber
718 1	4812 418 88024	Zubehoer Fluessigwasch. 4 K.
753 1	4819 418 68234	Luftkammer
754 0	4812 530 28826	Ablaufbalg
754 1	4812 530 28832	Verschluss eco
754 2	4812 530 28829	Flansch eco
760 0	4812 480 58105	Filter Set Pumpe
781 0	4819 530 28847	Ablaufschlauch
782 0	4812 530 28827	Schlauch Niveauschalter
787 0	4812 530 28813	Schlauch,Entl.
787 2	4819 401 18868	Schlauchschele 26,8 mm
794 5	4812 530 58095	Dichtung Luftkammer
900 0	4812 255 18204	Halter Ablaufschlauch
900 1	4812 290 88049	Halterung Tuerverriegelung
900 2	4812 290 88077	Kabelfuehrung
900 3	4812 401 18446	Kabelfuehrung
900 4	4819 401 18872	Schlauchschele Pumpe/Ablauf
900 5	4819 401 18529	Schlauchschele Bottich unten
900 6	4812 401 18444	Traeger Heizelement

Pos-Nr.	12NC	Beschreibung
900 7	4812 256 98031	Halter Niveauschalter
900 8	4819 401 18823	Klemme
901 3	4812 401 18549	Schlauchschele
910 0	4812 502 18383	Schraube Torx T40 M 8X 25
910 5	4812 502 18516	Schraube 4,2 x 13
930 0	4819 492 38139	Feder Aufhaengung
941 0	4812 520 28004	Kugellager 6206
941 1	4812 520 28072	Kugellager 6303
953 0	4812 530 58099	Wellendichtring 1200
961 0	4819 532 68829	Distanzstueck 44, 50, 58 l
965 0	4812 466 68545	Abdeckung BK/WH
993 0	4819 530 29028	Einhaengebogen
993 3	4812 395 58004	Werkzeug

Explosionszeichnung

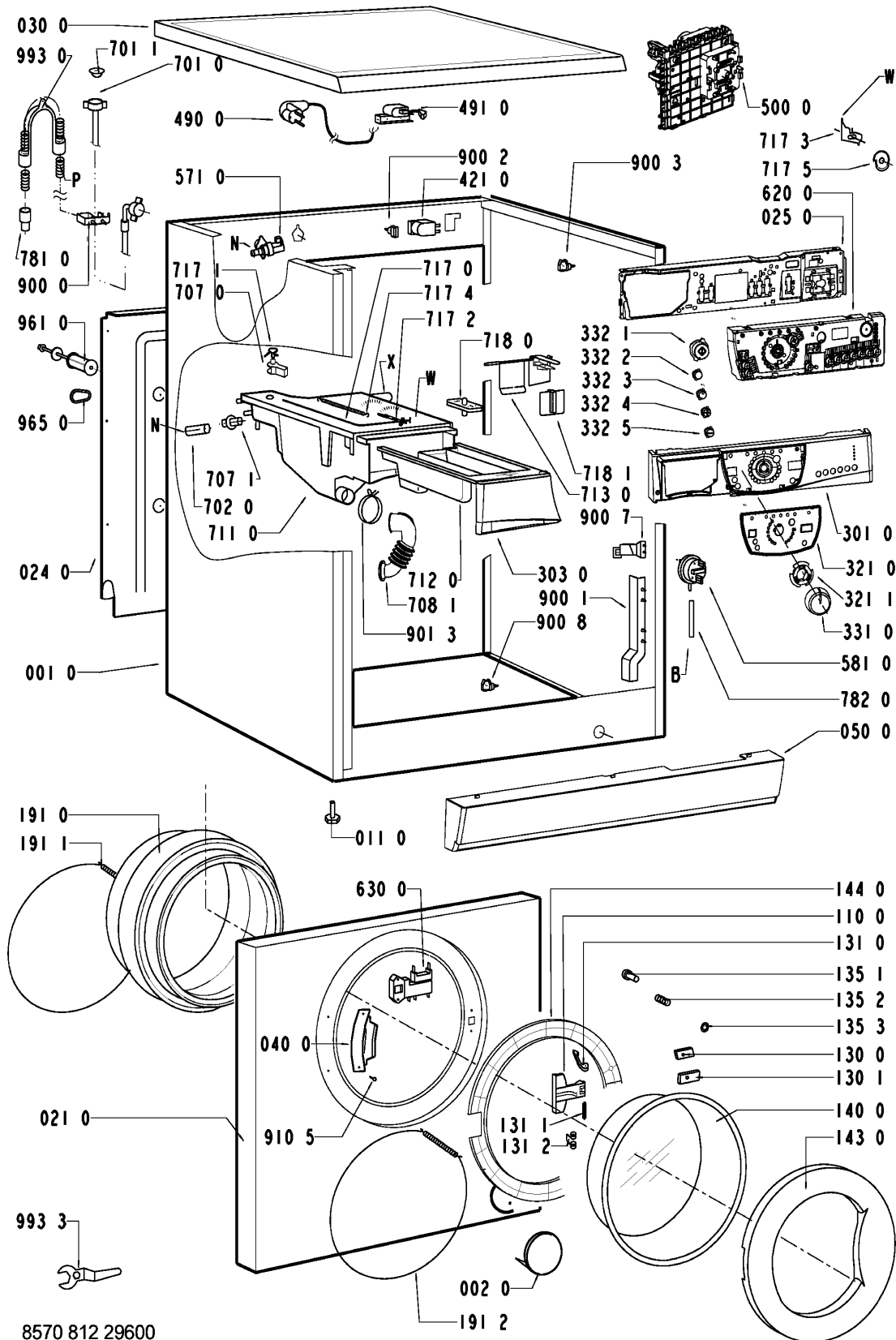

8570 812 29600

Explosionszeichnung

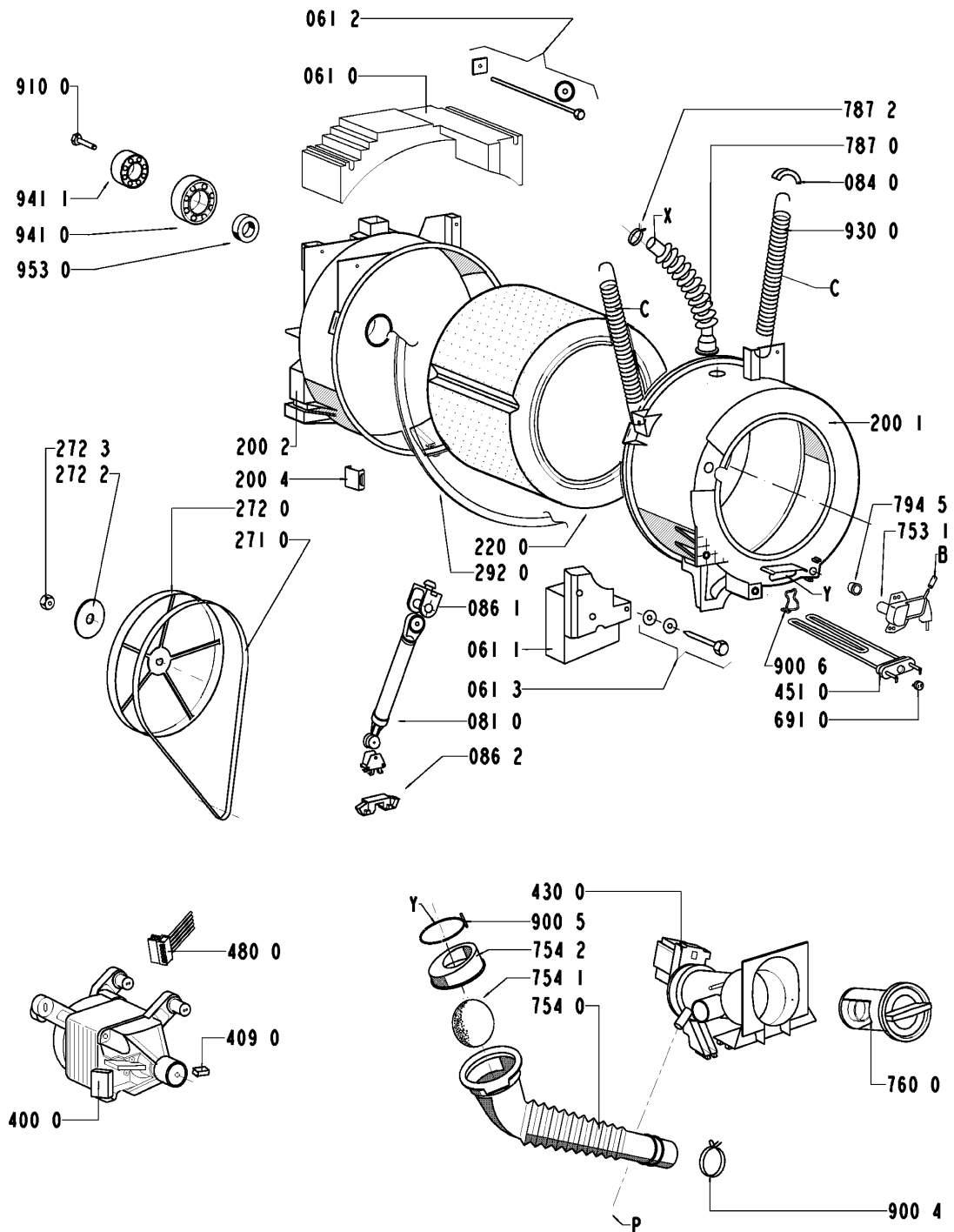

8570 812 29600

Anschlußplan

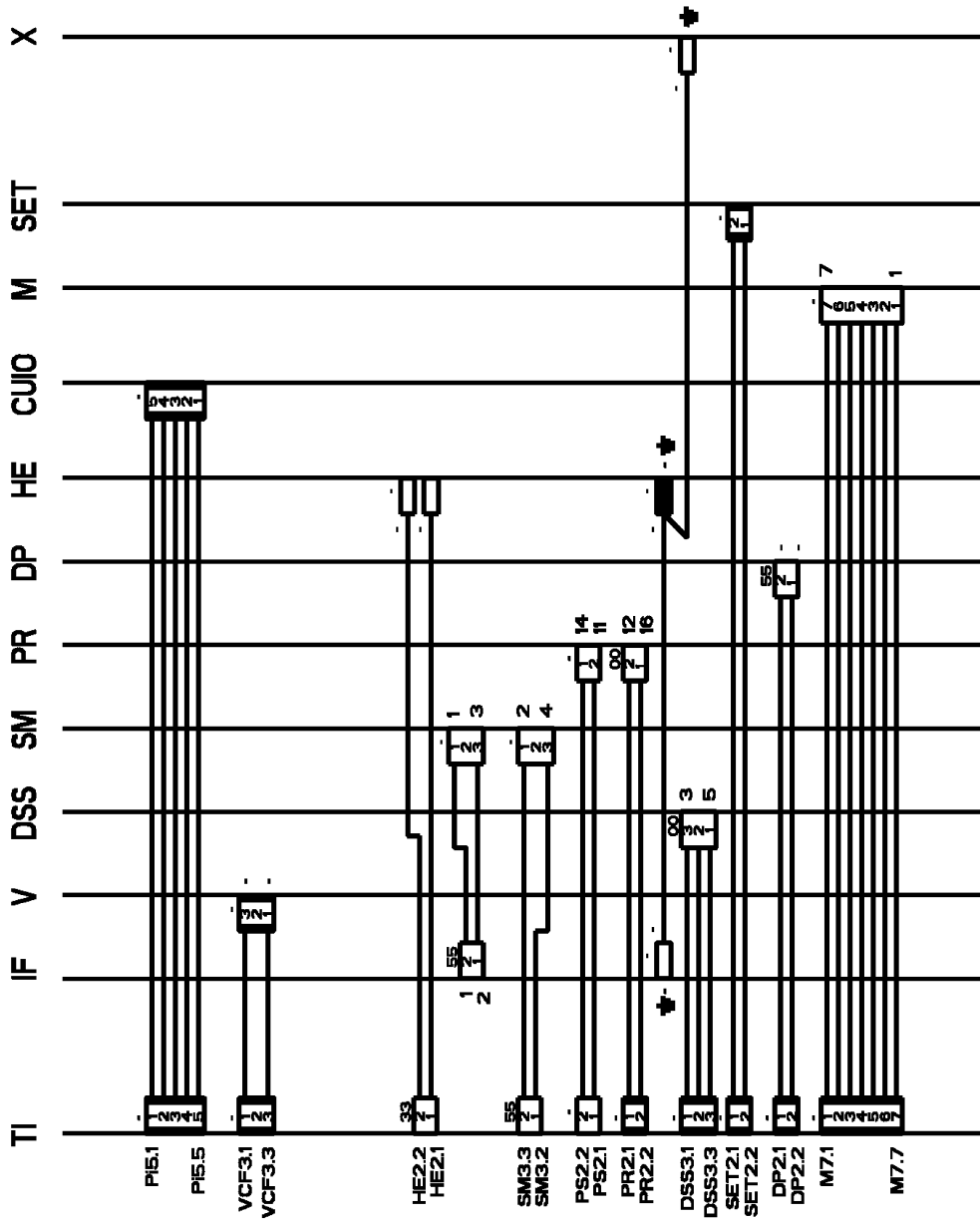

- | | |
|----|--------------|
| 00 | black |
| 11 | brown |
| 22 | red |
| 33 | orange |
| 44 | yellow |
| 55 | green |
| 66 | blue |
| 77 | violet |
| 88 | grey |
| 99 | white |
| 45 | yellow/green |

4619 744 43101

Stromlaufplan

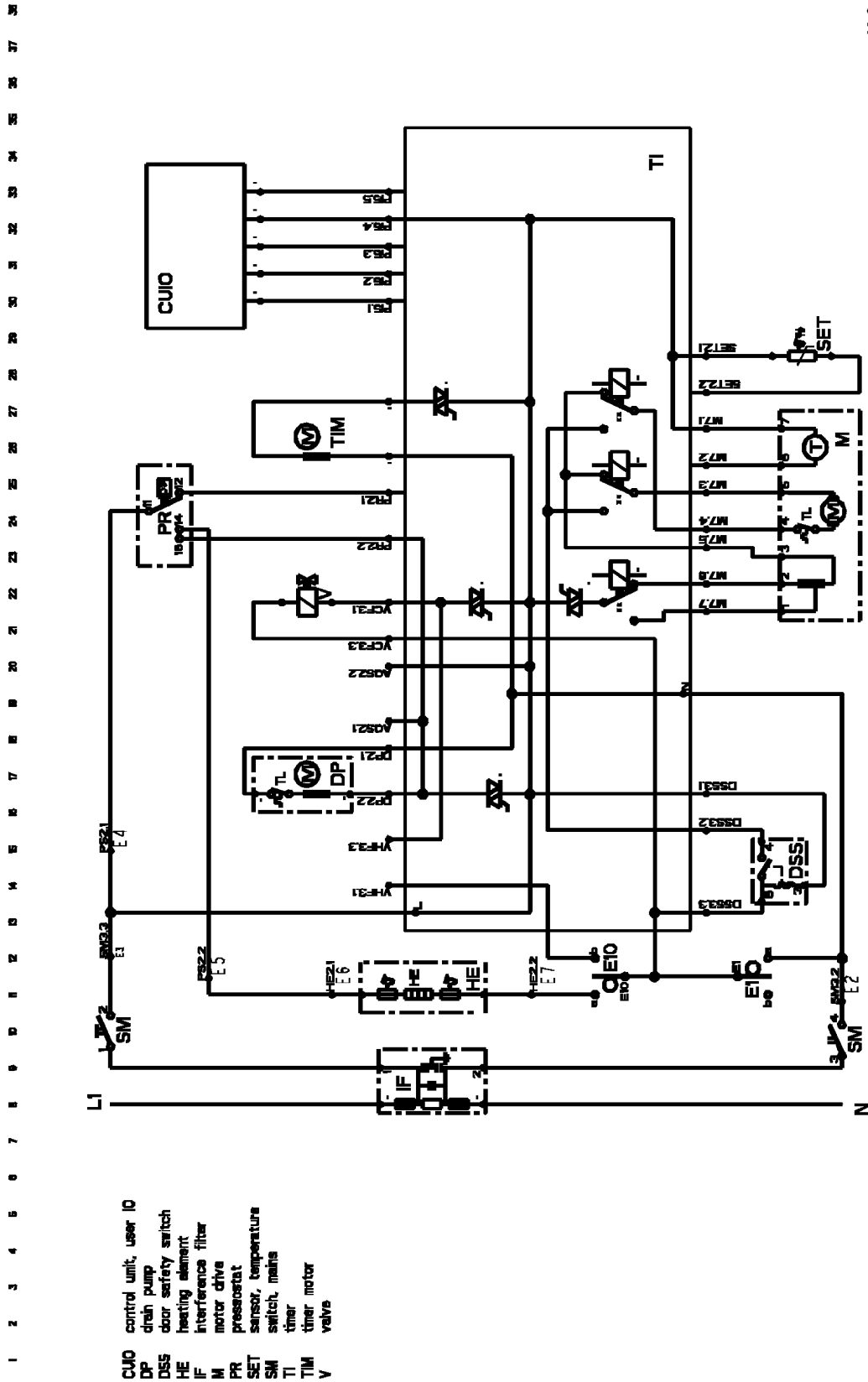

4618 744 43101

Programmablaufplan

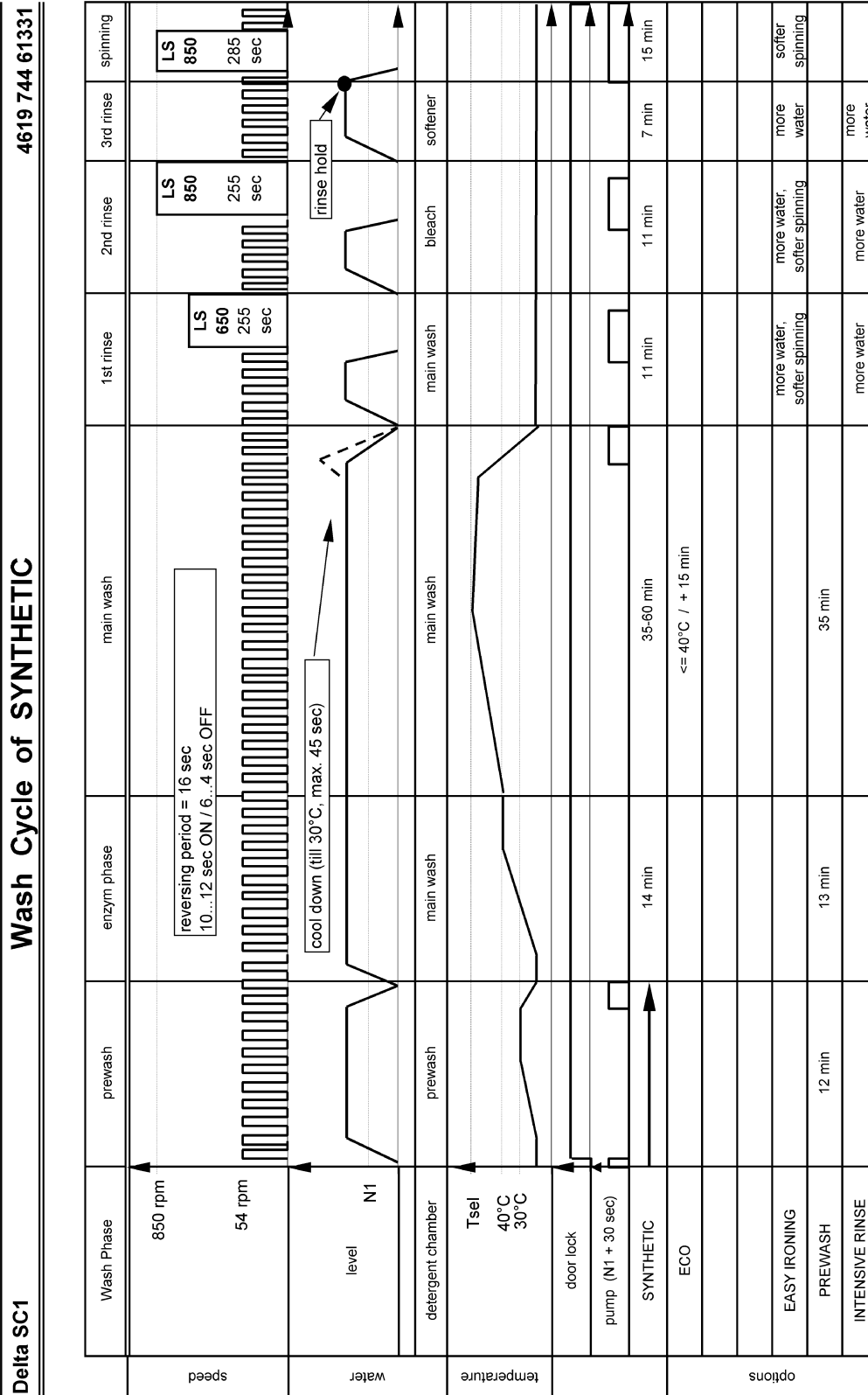

Programmablaufplan

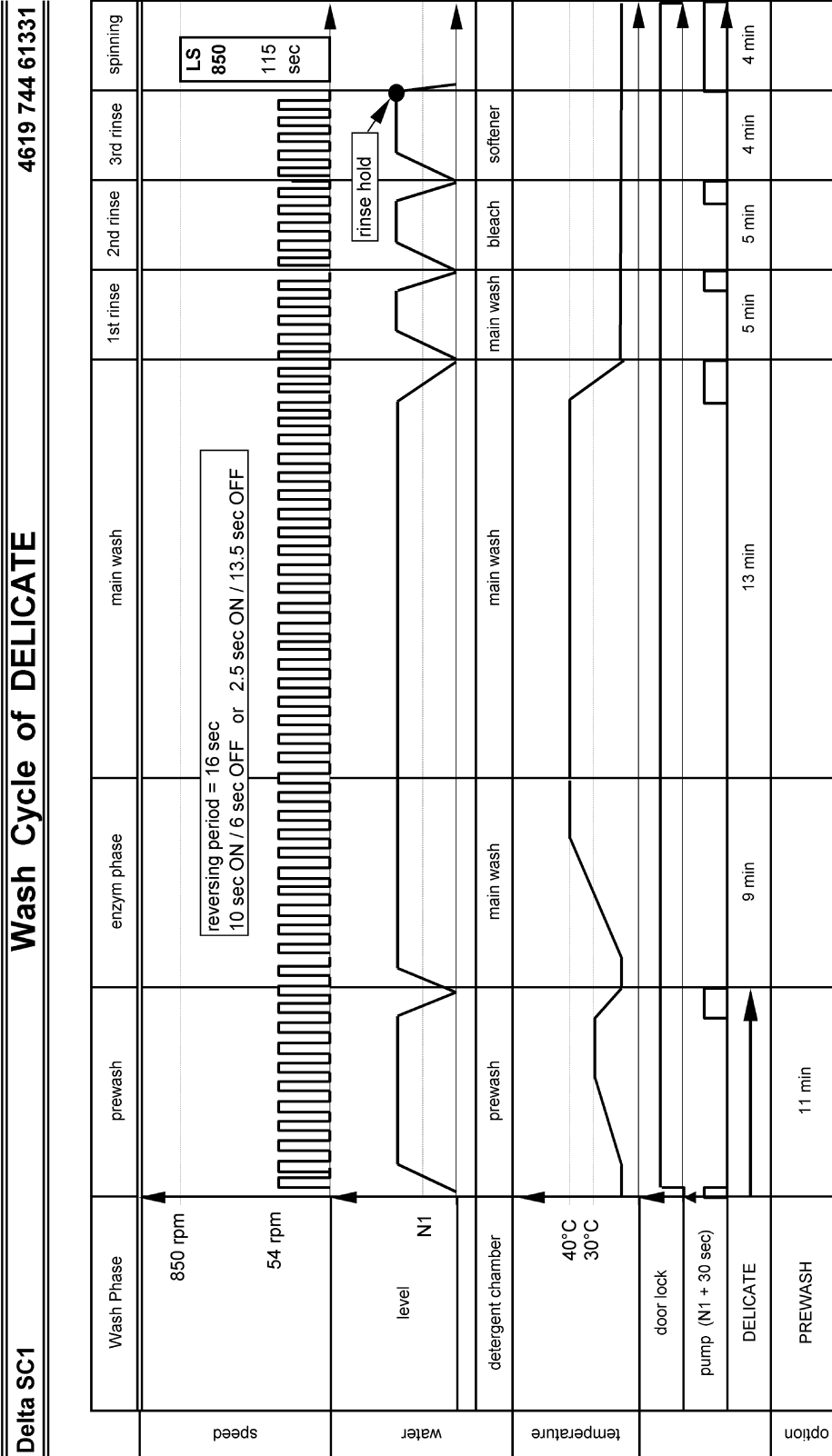

Programmablaufplan

4619 744 61331

Wash Cycles of WOOL and SILK

Delta SC1

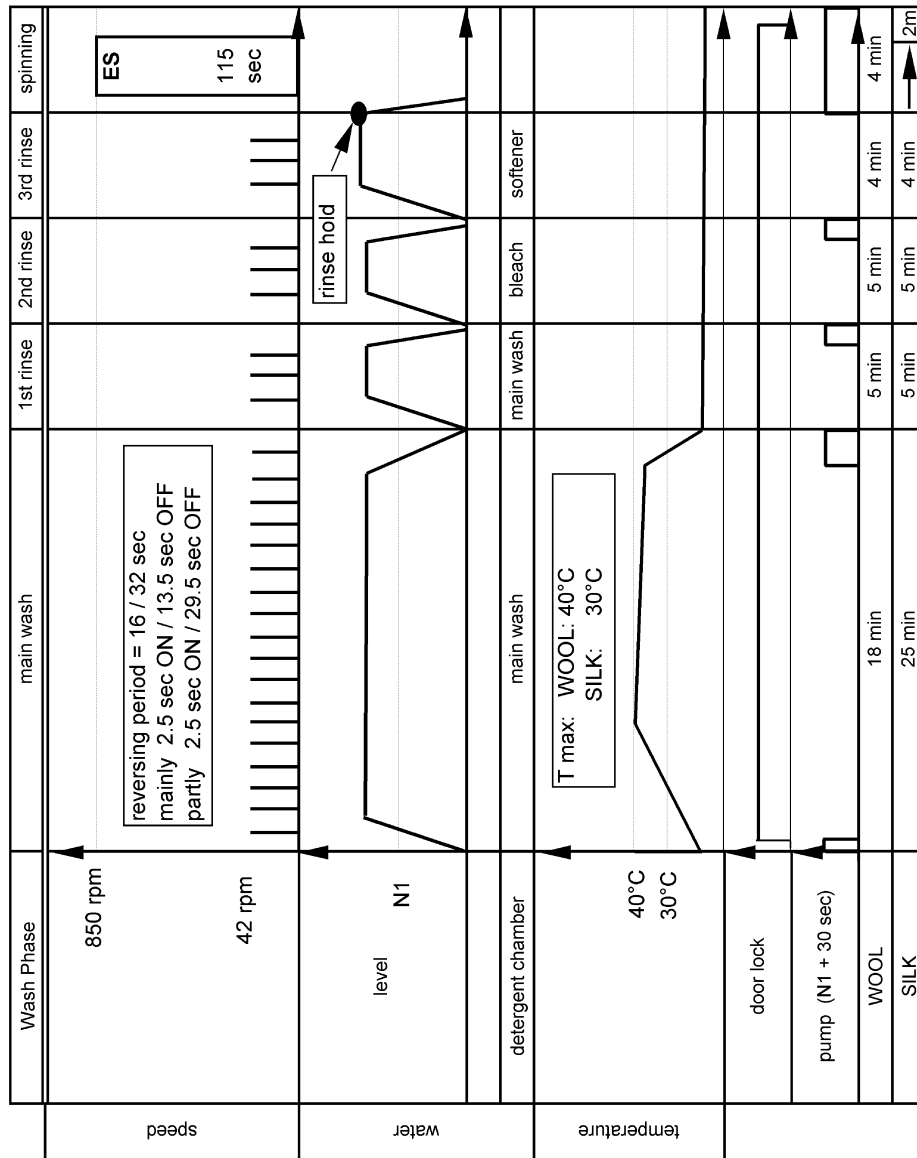

Programmablaufplan

4619 744 61331

Spinning Profiles

Delta SC1

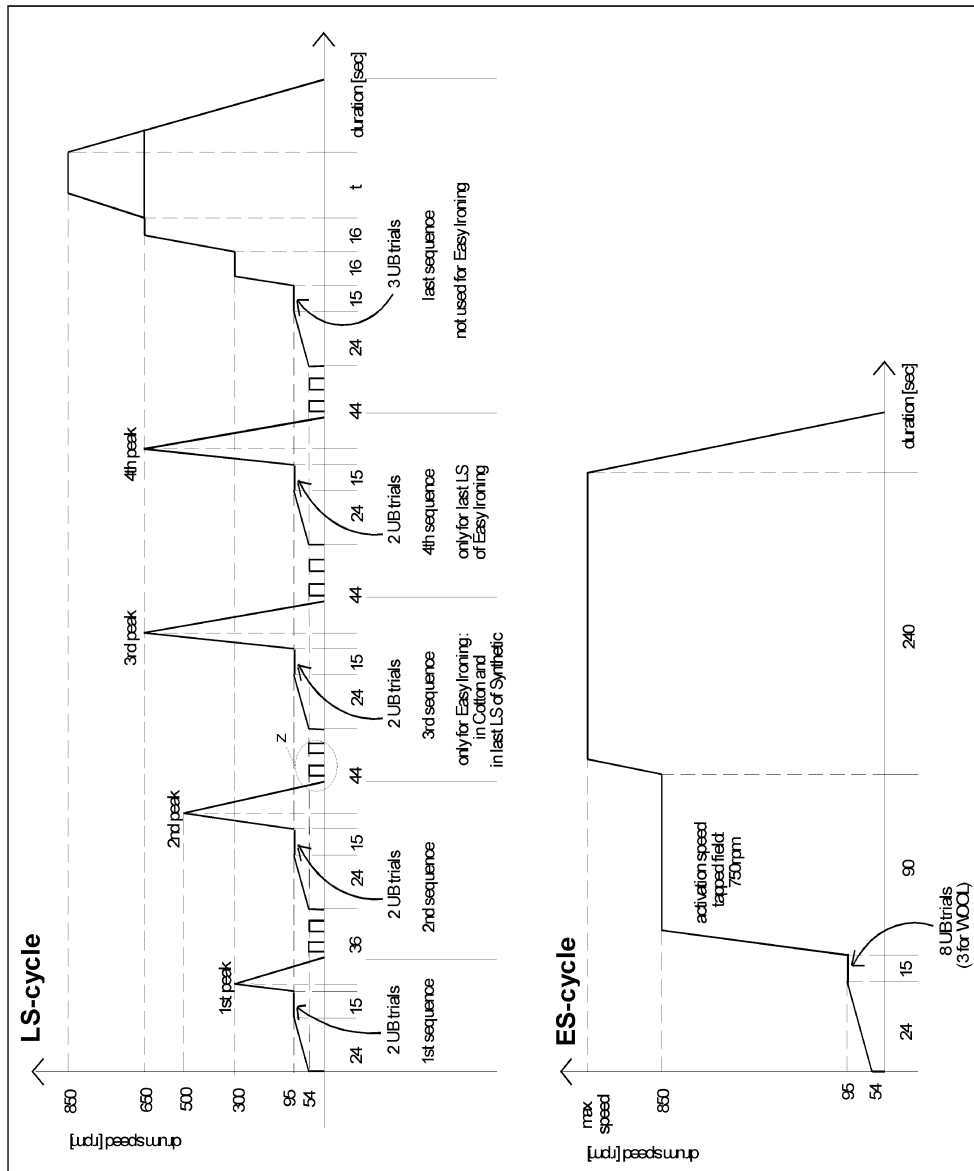

Text /Legende

Whirlpool SC1 VBL Version A and B test flow

1. **Attention : Use test program without laundry !!**

2. **Selecting the program :**

Select the Drain program by turning the main selector. Wait until the display shows 0:02 and till the pump has stopped

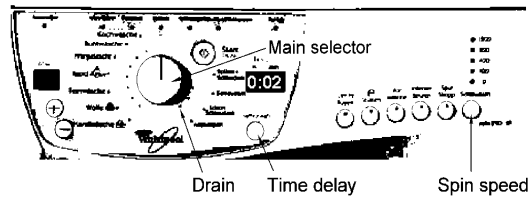

3. **Start of test program :**

Press PB1 twice, then PB2 twice and then the start button.

Indication of entering the test program:
 - temperature display = 60°C
 - delay start display = 0:00
 - speed LED max = ON
 - LED of PB1 and PB2 = ON

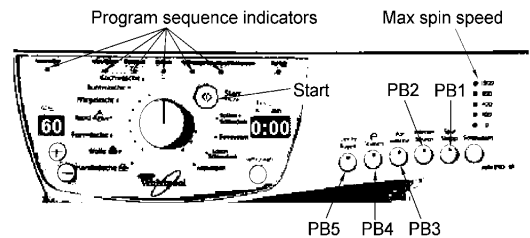

4. **Stopping the test program :**

Stop by moving the main selector into any other position.
 - note - no stop of test program by main interruption.

Testprogram for Whirlpool SC 1 timer VBL version A or B (Central program selector).

Position of timer	Program sequence LED's							Detergent box	Inlet / Outlet	Max temp.	Duration (" = sec) (' = min)	Movement of drum	Advance condition	Advance by option button (Press slowly twice)	Checking	
	Pre-wash	Main-wash	Rinse	Rinse hold	Spin-ning	Aqua-stop										
-	X	X	X	X	X	X	-					no movement		PB 3	PB 1, PB 2	
6	X	X	X	X	X	X	pre wash	fill		60°		no movement		PB 3	PB 3	
8							main wash	(hot) fill	hot fill	60°		no movement		PB 4 **, PB 1	PB 4, mainwash fill, hot fill N1	
16		X	X	X	X			fill			6'		gentle wash	N 1		
18								fill					gentle wash	60°	PB 1	
20								(fill)	90°C		55'		gentle wash	till 90°C - time unknown	PB 1	heating, NTC leakage
23				X	X	X	bleach *	fill				turns right	3"			
27							softener	fill				turns right	60°	PB 5 ** or PB 1	PB 5, bleach fill	
28				X	X		-	pump		6'		gentle wash	N 1	PB 1	PB 6 **, softener fill	
29						X	-	pump				0 - 95 rpm	4", N 1		pump, N1	
							-	pump				select. Speed	300", N 1	PB 1	motor - spinning	
5							-					no movement	∞			

** if PB 4 / PB 5 / PB 6 are present they must be used to advance to next step - if not present - use PB1 instead.

* 4 chamber detergent dispenser "bleach compartment"
 3 chamber detergent dispenser "main wash" compartment

Reaction to failure:

Timer SC1 goes into safety routine

- drain to level 1+30 sec. (time out for draining = 6 minutes)
- stop motor (relais in safety position)
- stop valve
- go out of heating step, if time out is reached

4619 712 54471

Text /Legende

Table of failures:

Failure Identifier	Indication	Detected failure	To be checked
1	FH	No water inlet	Water Tap / Valve / Flowmeter / Pressostat
2	FA	Aquastop failure	Aquastop switch
3	FP	Drain failure	Drain pump / Pressostat
4		Not active	
5	F05	NTC failure (SC / OC)	NTC
6	F06	Tachometer failure (no motor movement detected)	Motor / Tachometer
7	F07	Triac short circuit detection	Control unit, Motor
8		Not active	
9	F09	Overflow failure	Pressostat
10		Not active	
11	F11	Communication failure	Control unit, I2C bus
12		Not active	
13		Not active	
14	F14	EEPROM failure	Control unit
15		Not active	
16	F16	Control failure	Control unit
17		Not active	
18	F18	Control failure	Control unit
19		Not active	
20	F20	Control failure	Control unit
21	F21	Control failure	Control unit

Display of failures on the speed LED's (flashing):

Errors	1	2	3	4	5	6	7	8	9	10	11	12	13	14	15
	F:H	F:A	F:P	F:4	F:5	F:6	F:7	F:8	F:9	F:10	F:11	F:12	F:13	F:14	F:15
Speed Leds	○	○	○	○	○	○	○	○	○	○	○	○	○	○	○
	○	○	○	○	●	●	●	○	●	○	●	○	○	●	○
	○	○	○	○	○	○	○	○	○	○	○	○	○	○	○
	●	○	●	○	●	○	●	○	●	○	●	○	○	○	○

Errors	16	17	18	19	20	21
	F:16	F:17	F:18	F:19	F:20	F:21
Speed Leds	●	○	●	○	●	●
	○	○	○	○	○	○
	○	○	○	○	○	○
	○	○	○	○	○	○

4619 712 54471

Text /Legende

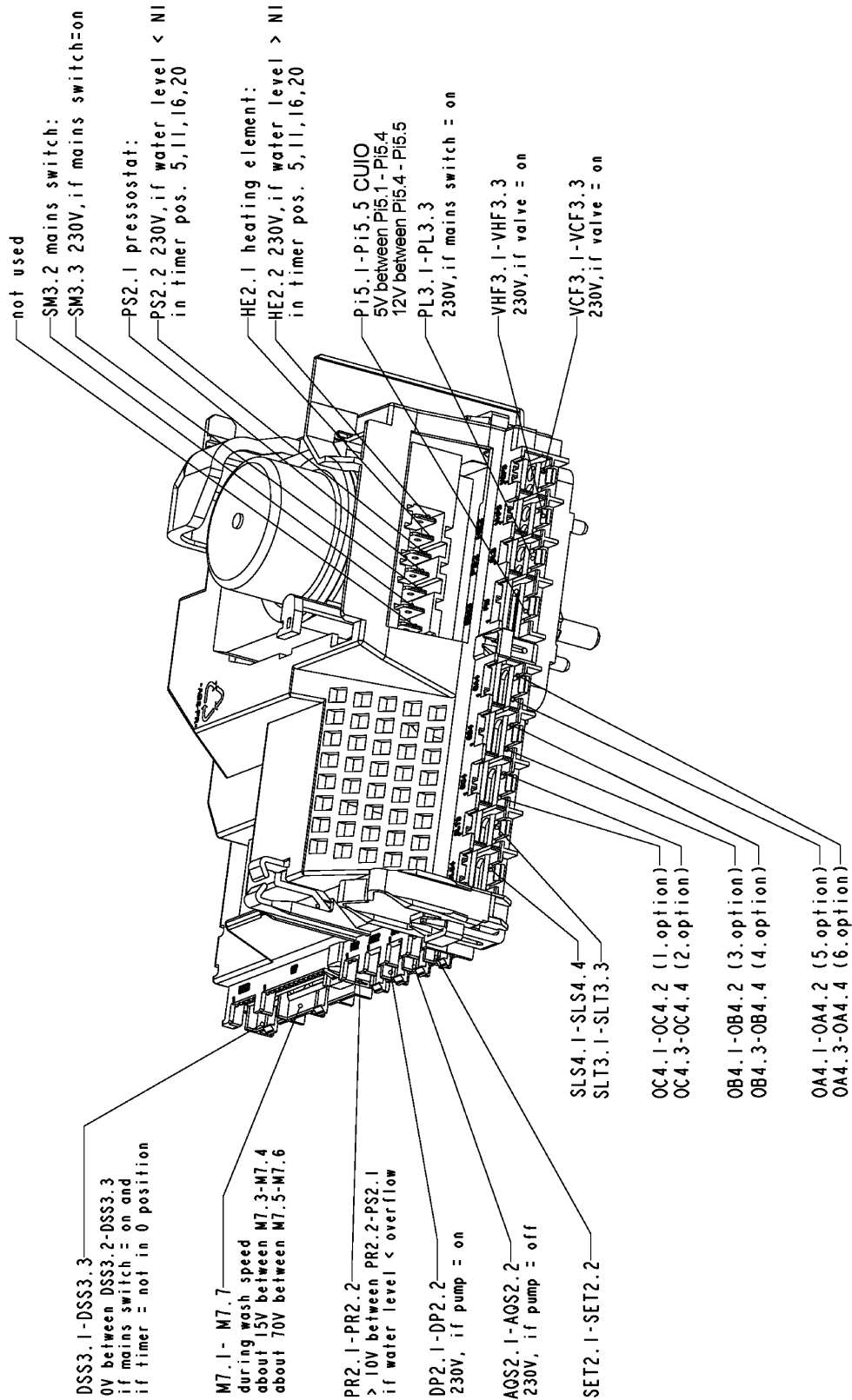

4619 712 54471